

Adjustable From Top Face With Flat-Blade Screwdriver

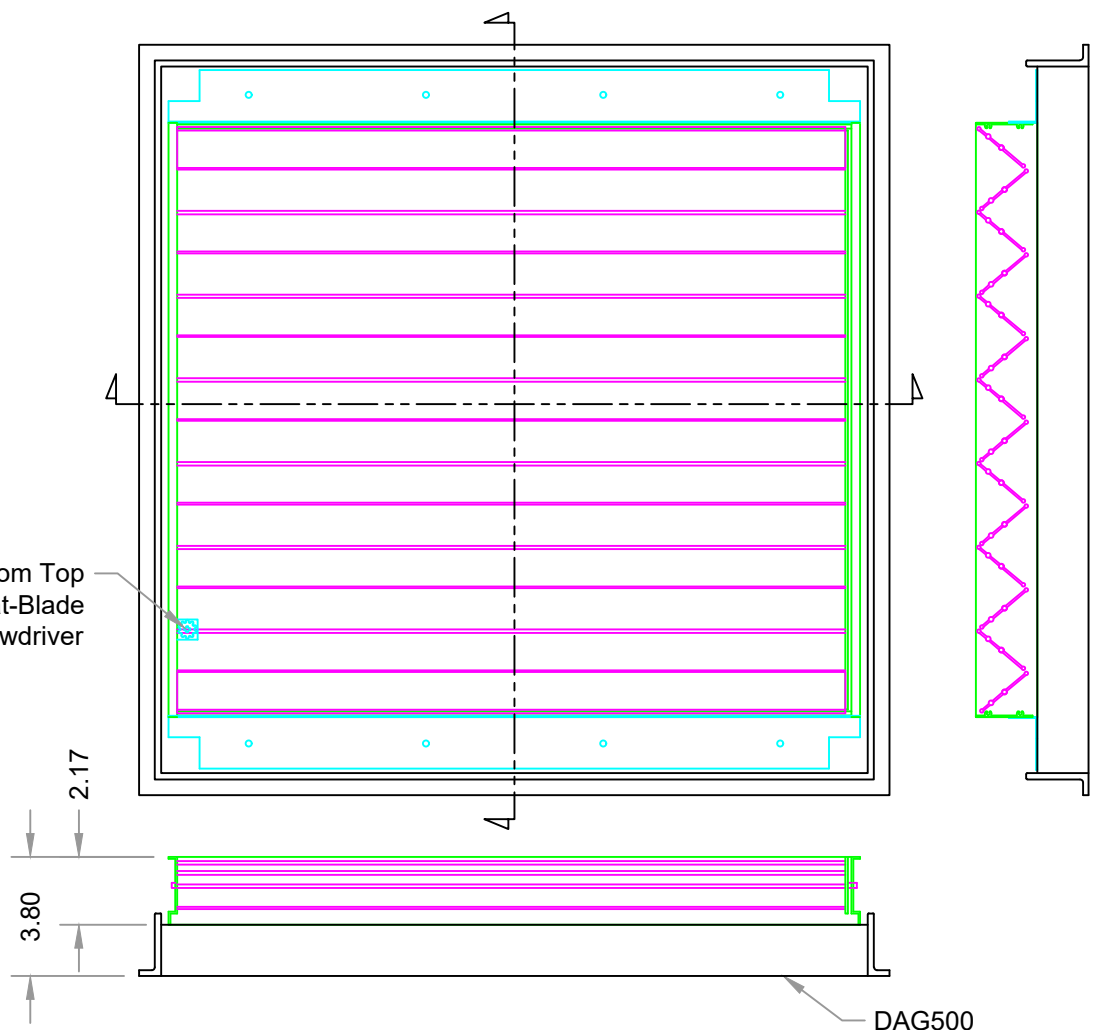

DAG500
DIRECTIONAL AIR
FLOW GRATE
24" or 600mm Size

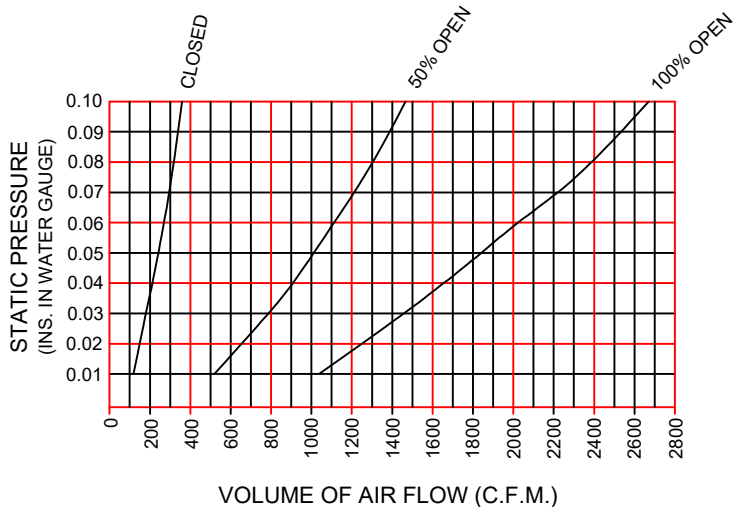

FEATURES:

- Extruded Aluminum Construction
- 100% Variable Damper Settings
- Adjustable From Top Of Panel
- 1/4 Turn For Full Adjustment

NOTE: Cut-Sheet drawing and specifications are subject to change without prior notice.

**OPPOSED BLADE DAMPER
FOR DAG500 DIRECTIONAL
AIR FLOW GRATE**



9500 Industrial Center Dr.
Ladson, SC, 29456
www.asmproducts.com

Tel: 843-534-1110
Fax: 843-534-1111